

LANDSCAPE LEGEND:

	TURFGRASS SEED
	HARDWOOD BARK MULCH PLANT BED
	STONE MULCH
	NATIVE SEED MIX
	BIOFILTRATION PERENNIAL PLUGS
	PROPERTY LINE
	PLANT EDGING
	SHEET MATCHLINE

- EXISTING TREE TO REMAIN (DBH > 8")
- PROPOSED RETAINING WALL, SEE GRADING PLAN
- CONSERVATION EASEMENT LINE
- MARKET TENT

CONCEPT PLANT SCHEDULE

	CANOPY TREE Betula nigra / River Birch Celtis occidentalis 'Chicagoland' / Chicagoland Hackberry Liriodendron tulipifera 'JFS-Oz' / Emerald City® Tulip Poplar Platanus occidentalis / American Sycamore Quercus bicolor / Swamp White Oak Ulmus americana 'Princeton' / Princeton American Elm	158	10' Ht., B&B 2.5' Cal., B&B 2.5' Cal., B&B 2.5' Cal., B&B 2.5' Cal., B&B
	DECORATIVE TREE Amelanchier x grandiflora 'Autumn Brilliance' / Autumn Brilliance Apple Serviceberry Cercis canadensis / Eastern Redbud Crataegus crus-galli inermis / Thornless Cockspur Hawthorn	146	6' Ht., B&B Multi-Stem 6' Ht., B&B Multi-Stem 6' Ht., B&B Multi-Stem
	EVERGREEN TREE Abies concolor / White Fir Picea abies / Norway Spruce Pinus strobus / White Pine	25	6' Ht., B&B 6' Ht., B&B 6' Ht., B&B
	UPRIGHT TREE Magnolia x 'Ann' / Ann Magnolia Malus x 'Adirondack' / Adirondack Crabapple Malus x 'Spring Snow' / Spring Snow Crabapple Syringa reticulata 'Ivory Silk' / Ivory Silk Japanese Tree Lilac	24	1.5' Cal., B&B 1.5' Cal., B&B 1.5' Cal. (Multi), B&B 1.5' Cal., B&B
	UPRIGHT EVERGREEN Juniperus chinensis 'Mountbatten' / Mountbatten Juniper Juniperus x 'J.N Select Blue' / Star Power® Juniper Thuja occidentalis 'Dark Green' / Dark American Arborvitae	84	6' Ht., B&B 6' Ht., B&B 6' Ht., B&B

CONCEPT SHRUB AND PERENNIAL PLANT PALETTE

DECIDUOUS SHRUB
 Aronia melanocarpa 'UCONNAM166' / Low Scape Hedger® Black Chokeberry
 Cornus alba 'Bailhalo' / Ivory Halo® Tatarian Dogwood
 Cornus sericea 'Cardinal' / Cardinal Red Twig Dogwood
 Hydrangea paniculata 'LVOB' / Bobo® Panicle Hydrangea
 Hydrangea paniculata 'Limelight' / Limelight® Panicle Hydrangea
 Physocarpus opulifolius 'Donna May' / Little Devil™ Dwarf Ninebark
 Physocarpus opulifolius 'SMNPOBLR' / Ginger Wine® Ninebark
 Rhus aromatica 'Gro-Low' / Gro-Low Fragrant Sumac
 Salix purpurea 'Nana' / Dwarf Purple Osier Willow
 Spiraea betulifolia 'Tor' / Tor Birchleaf Spirea
 Weigela florida 'Bokraspiw' / Spilled Wine® Weigela

EVERGREEN SHRUB
 Buxus x 'Green Mound' / Green Mound Boxwood
 Buxus x 'Green Mountain' / Green Mountain Boxwood
 Juniperus chinensis 'Kallays Compact' / Kallay Compact Pfitzer Juniper
 Juniperus chinensis 'Sea Green' / Sea Green Juniper
 Juniperus horizontalis 'Blue Chip' / Blue Chip Creeping Juniper
 Juniperus horizontalis 'Youngstown' / Creeping Juniper
 Taxus x media 'Densiformis' / Dense Anglo-Japanese Yew
 Taxus x media 'Everlow' / Everlow Anglo-Japanese Yew
 Taxus x media 'Hicksii' / Hicks Anglo-Japanese Yew
 Tsuga canadensis 'Gentish White' / Gentish White Eastern Hemlock

PERENNIAL
 Agastache x 'Blue Fortune' / Blue Fortune Anise Hyssop
 Ajuga reptans 'Bronze Beauty' / Bronze Beauty Carpet Bugle
 Allium x 'Millenium' / Millenium Ornamental Onion
 Amsonia x 'Blue Ice' / Blue Ice Bluestar
 Artemisia schmidtiana 'Silver Mound' / Silver Mound Artemisia
 Astilbe chinensis 'Vision in White' / Vision in White Chinese Astilbe
 Athyrium niponicum pictum 'Silver Falls' / Silver Falls Japanese Painted Fern
 Baptisia australis / Blue Wild Indigo
 Brunnera macrophylla 'Queen of Hearts' / Queen of Hearts Siberian Bugloss
 Echinacea purpurea 'Kim's Knee High' / Kim's Knee High Coneflower
 Echinacea purpurea 'White Swan' / White Swan Coneflower
 Geranium x 'Gerwat' / Rozanne Geranium
 Hemerocallis x 'Bela Lugosi' / Bela Lugosi Daylily
 Heuchera x 'Palace Purple' / Palace Purple Coralbells
 Hosta x 'Halcyon' / Halcyon Hosta
 Leucanthemum x superbum 'Becky' / Becky Shasta Daisy
 Liatris spicata 'Kobold' / Kobold Blazing Star
 Monarda x 'Leading Lady Plum' / Leading Lady Plum Bee Balm
 Nepeta x 'Cat's Pajamas' / Cat's Pajamas Catmint
 Phlox x 'Minnie Pearl' / Minnie Pearl Hybrid Phlox
 Salvia x sylvestris 'May Night' / May Night Sage
 Symphyotrichum novae-angliae 'Purple Dome' / Purple Dome New England Aster

ORNAMENTAL GRASS
 Calamagrostis x acutiflora 'Overdam' / Overdam Feather Reed Grass
 Carex flacca 'Blue Zinger' / Blue Zinger Sedge
 Eragrostis spectabilis / Purple Lovegrass
 Erianthus ravennae / Ravenna Grass
 Miscanthus sinensis 'Gracillimus' / Eulalia Grass
 Pennisetum alopecuroides 'Burgundy Bunny' / Burgundy Bunny Dwarf Fountain Grass
 Schizachyrium scoparium 'Twilight Zone' / Twilight Zone Little Bluestem
 Sporobolus heterolepis 'Tara' / Tara Prairie Dropseed

LANDSCAPE GENERAL NOTES:

- VERIFY EXISTING AND PROPOSED CONDITIONS, UTILITIES, PIPES, AND STRUCTURES, ETC. PRIOR TO BIDDING AND CONSTRUCTION.
- INSPECT THE SITE PRIOR TO COMMENCING WORK. DOCUMENT IN WRITING AND PHOTOGRAPH EXISTING CONDITIONS WITHIN, AND IN AREAS ADJACENT TO THE LIMITS OF CONSTRUCTION. THE LANDSCAPE CONTRACTOR IS RESPONSIBLE FOR ANY DAMAGES NOT DOCUMENTED IN THE PHOTOGRAPHS PRIOR TO COMMENCEMENT OF DEMOLITION ACTIVITIES.
- COORDINATE THE INSTALLATION OF PLANT MATERIAL WITH INSTALLATION OF ADJACENT PAVEMENTS, DRAINAGE, CURB RELATED STRUCTURES WITH OTHER TRADES.
- RESTORE AREAS OF THE SITE, OR ADJACENT AREAS, WHERE DISTURBED. DAMAGE CAUSED DURING LANDSCAPE INSTALLATION TO EXISTING CONDITIONS AND IMPROVEMENTS IS THE RESPONSIBILITY OF THE LANDSCAPE CONTRACTOR.
- CONTRACTOR SHALL THOROUGHLY REVIEW ALL SPECIFICATIONS RELATED TO TREE PROTECTION, SOIL PREPARATION, TURF, GRASSES AND PLANTS. THESE SECTIONS PROVIDE ADDITIONAL INFORMATION ON MATERIALS AND SET STANDARDS FOR QUALITY AND INSTALLATION REQUIREMENTS.
- PROVIDE 3" DOUBLE SHREDDED BARK MULCH FOR ALL PLANTED TREES, SHRUBS AND LANDSCAPE BEDS.

THE SIGMA GROUP
 Single Source. Sound Solutions.
 www.thesigmagroup.com
 1300 West Canal Street
 Milwaukee, WI 53233
 Phone: 414-643-4200
 Fax: 414-643-4210

7044 South Ballpark Drive Suite 305
 Franklin, WI 53132
 Phone: 414-285-3470

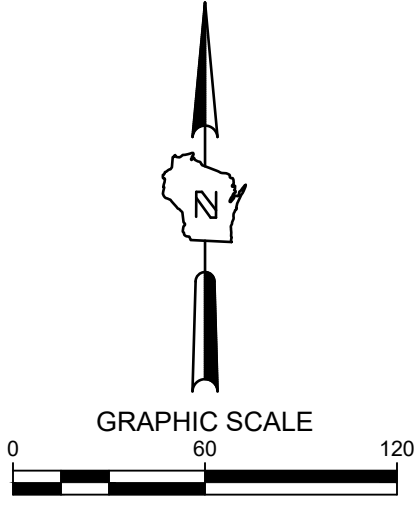

POTHS GENERAL DEVELOPMENT
 76TH AND RAWSON
 FRANKLIN, WI 53132
 OVERALL LANDSCAPE PLAN

PRELIMINARY
 NOT FOR
 CONSTRUCTION

ISSUANCE	DATE

NO. REVISION	DATE

SCALE:	1" = 60'
PROJECT NO:	21775
DESIGN DATE:	---
PLOT DATE:	2023.10.13
DRAWN BY:	MJK
CHECKED BY:	JL
APPROVED BY:	CTC
SHEET NO:	L100

PRELIMINARY
 NOT FOR
 CONSTRUCTION

ISSUANCE DATE

NO. REVISION DATE

SCALE:	
PROJECT NO:	21775
DESIGN DATE:	---
PLOT DATE:	2023.10.13
DRAWN BY:	MJK
CHECKED BY:	JL
APPROVED BY:	CTC
SHEET NO:	

L200

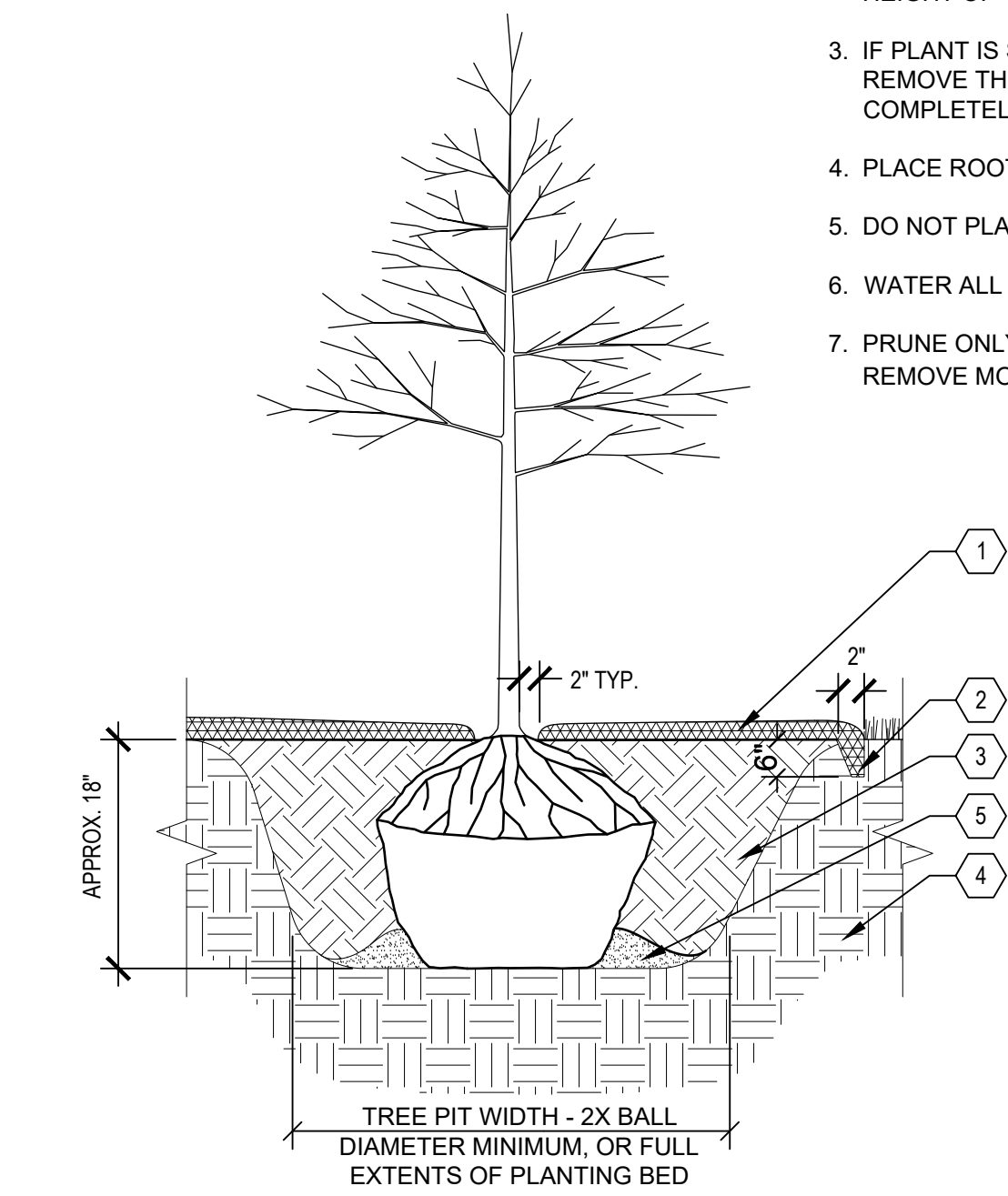

A TYPICAL TREE PLANTING
 SCALE: NTS

- NOTES:
- PLANT EACH TREE SUCH THAT THE ROOT FLARE IS VISIBLE AT THE TOP OF THE ROOT BALL. DO NOT COVER THE TOP OF THE ROOT BALL WITH SOIL.
 - DEPTH OF THE PLANTING HOLE SHOULD BE DETERMINED AND DUG AFTER THE ROOT FLARE IS LOCATED. PLANTING HOLE MUST BE NO DEEPER THAN THE HEIGHT OF THE ROOT BALL.
 - IF PLANT IS SHIPPED WITH A WIRE BASKET AROUND THE ROOT BALL, CUT AND REMOVE THE WIRE BASKET ENTIRELY. REMOVE ALL TWINE, ROPE, AND BURLAP COMPLETELY FROM ALL ROOT BALLS.
 - PLACE ROOT BALL ON UNEXCAVATED OR TAMPED SOIL.
 - DO NOT PLACE MULCH IN CONTACT WITH STEMS.
 - WATER ALL PLANTS WITHIN 2 HOURS OF INSTALLATION.
 - PRUNE ONLY AS NECESSARY TO REMOVE UNHEALTHY BRANCHES. DO NOT REMOVE MORE THAN 1/2 OF THE ORIGINAL PLANT MASS.

KEYED LEGEND

- 1 3" DEPTH SHREDDED HARDWOOD BARK MULCH. PROVIDE 4'-0" DIAMETER MULCH RINGS AT THE BASE OF ANY TREES PLANTED IN LAWN.
- 2 PROVIDE SPADED EDGE, 2" WIDE, 6" DEEP FOR ENTIRE PERIMETER OF BARK MULCH RINGS AT BASE OF TREES PLANTED IN LAWNS
- 3 PLANTING SOIL, PLANTING SOIL SHALL BE PLACED IN ONE CONTINUOUS VOLUME FOR THE ENTIRE AREA OF ANY GIVEN PLANT BED.
- 4 PREPARED SUBGRADE
- 5 TAMP SOIL AROUND BALL BASE FIRMLY WITH FOOT PRESSURE SO THAT BALL DOES NOT SHIFT

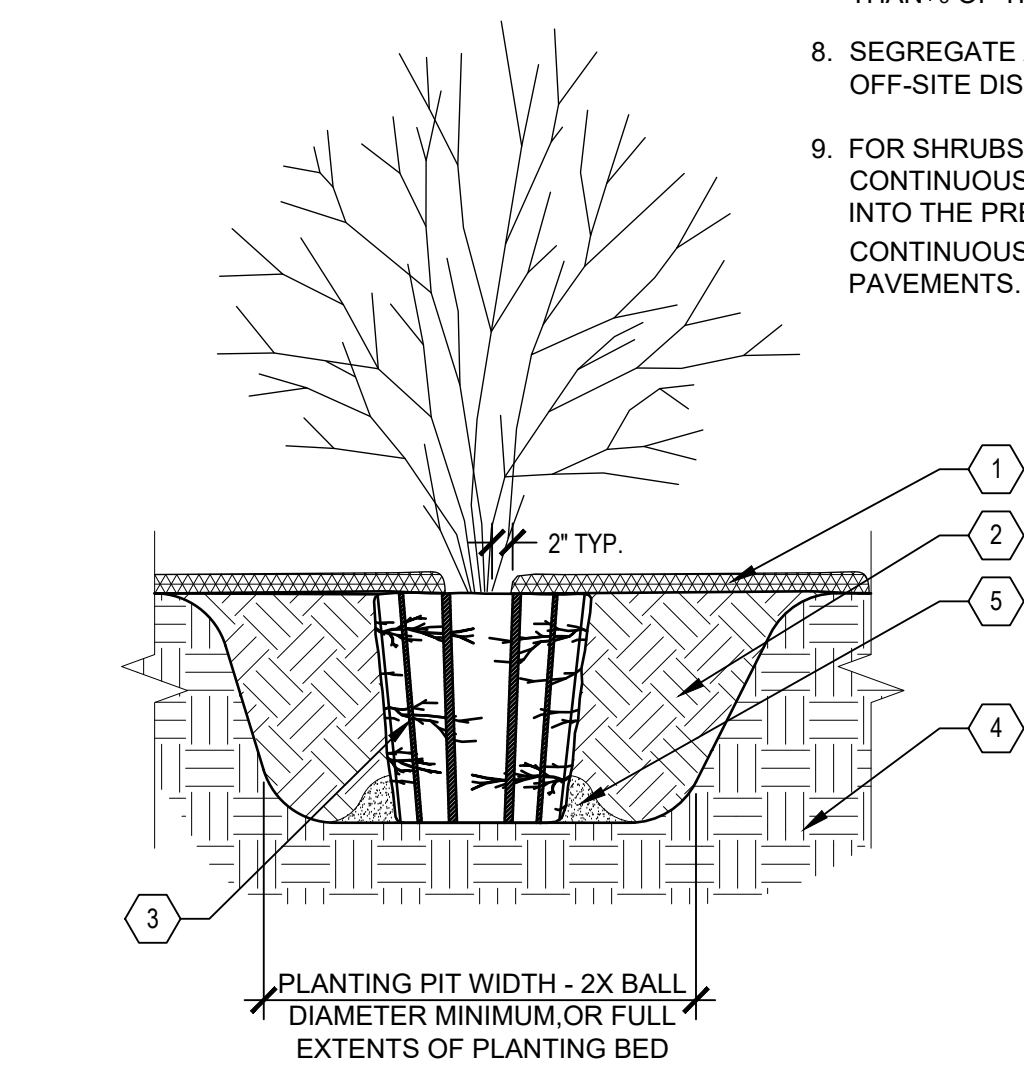

B TYPICAL SHRUB PLANTING
 SCALE: NTS

- NOTES:
- MAKE 1" TO 2" DEEP VERTICAL CUTS EVERY 6" AROUND THE CIRCUMFERENCE OF THE ROOT BALL BEFORE PLANTING TO LOOSEN POT-BOUND ROOTS.
 - PLANT EACH SHRUB SUCH THAT THE ROOT FLARE IS VISIBLE AT THE TOP OF THE ROOT BALL. DO NOT COVER THE TOP OF THE ROOT BALL WITH SOIL.
 - PLANTING HOLE MUST NOT BE DEEPER THAN THE HEIGHT OF THE ROOT BALL.
 - DO NOT PLACE MULCH IN CONTACT WITH STEMS.
 - PLACE ROOT BALL ON UNEXCAVATED OR TAMPED SOIL.
 - WATER ALL PLANTS WITHIN 2 HOURS OF INSTALLATION.
 - PRUNE ONLY AS NECESSARY TO REMOVE UNHEALTHY BRANCHES. DO NOT REMOVE MORE THAN 1/2 OF THE ORIGINAL PLANT MASS.
 - SEGREGATE ANY SOIL FROM BELOW WARNING LAYER EXCAVATED DURING PLANTING FOR OFF-SITE DISPOSAL. COORDINATE DISPOSAL WITH ENVIRONMENTAL CONSULTANT.
 - FOR SHRUBS PLANTED WITHIN PLANTING BEDS, CONTRACTOR SHALL PROVIDE PLANTING SOIL CONTINUOUSLY FOR THE ENTIRE PLANTING BED AND INDIVIDUAL SHRUBS SHALL BE PLANTED INTO THE PREPARED PLANTING SOIL. MULCH SURFACE FOR PLANTING BEDS SHALL ALSO BE CONTINUOUS ACROSS THE ENTIRE SURFACE AND HELD 1/2" MIN. TO 1" MAX. BELOW ADJACENT PAVEMENTS.

KEYED LEGEND

- 1 3" DEPTH TWICE-SHREDDED HARDWOOD BARK MULCH, UNLESS OTHERWISE INDICATED, KEEP 2" CLEAR OF STEMS
- 2 PLANTING SOIL AS SPECIFIED, PLANTING SOIL SHALL BE PLACED IN ONE CONTINUOUS VOLUME FOR THE ENTIRE AREA OF ANY GIVEN PLANT BED
- 3 1" TO 2" DEEP VERTICAL CUTS EVERY 6" AROUND PERIMETER
- 4 PREPARED SUBGRADE
- 5 TAMP SOIL AROUND BALL BASE FIRMLY WITH FOOT PRESSURE SO THAT BALL DOES NOT SHIFT

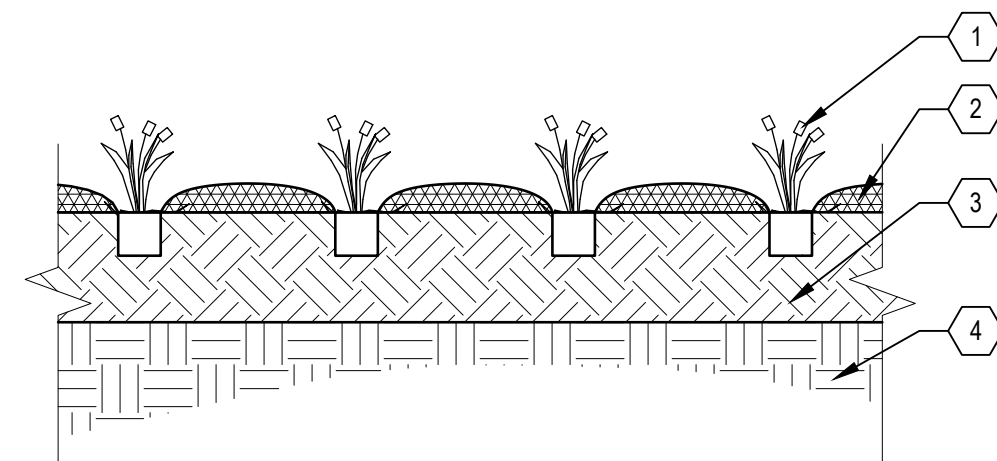

C TYPICAL PERENNIAL PLANTING
 SCALE: NTS

- NOTES:
- DO NOT COVER THE TOP OF THE ROOT BALL WITH SOIL.
 - PLANTING HOLE MUST NOT BE DEEPER THAN THE HEIGHT OF THE ROOT BALL.
 - DO NOT PLACE MULCH IN CONTACT WITH STEMS.
 - WATER ALL PLANTS THOROUGHLY WITHIN 2 HOURS OF INSTALLATION.
 - PRUNE ONLY AS NECESSARY TO REMOVE UNHEALTHY OR DEAD PLANT PARTS. DO NOT REMOVE MORE THAN 1/2 OF THE ORIGINAL PLANT MASS.
 - FOR PLANTS PLANTED WITHIN PLANTING BEDS, CONTRACTOR SHALL PROVIDE PLANTING SOIL CONTINUOUSLY FOR THE ENTIRE PLANTING BED AND INDIVIDUAL SHRUBS SHALL BE PLANTED INTO THE PREPARED PLANTING SOIL. MULCH SURFACE FOR PLANTING BEDS SHALL ALSO BE CONTINUOUS ACROSS THE ENTIRE SURFACE AND HELD 1/2" MIN. TO 1" MAX. BELOW ADJACENT PAVEMENTS.

KEYED LEGEND

- 1 PERENNIAL, ORNAMENTAL GRASS, OR GROUNDCOVER PLUG, SEE LANDSCAPE PLAN SHEETS L100-L103
- 2 3" DEPTH TWICE-SHREDDED HARDWOOD BARK MULCH, UNLESS OTHERWISE INDICATED, KEEP 3" CLEAR OF STEMS
- 3 PLANTING SOIL, PLANTING SOIL SHALL BE PLACED IN ONE CONTINUOUS VOLUME FOR THE ENTIRE AREA OF ANY GIVEN PLANT BED
- 4 PREPARED SUBGRADE

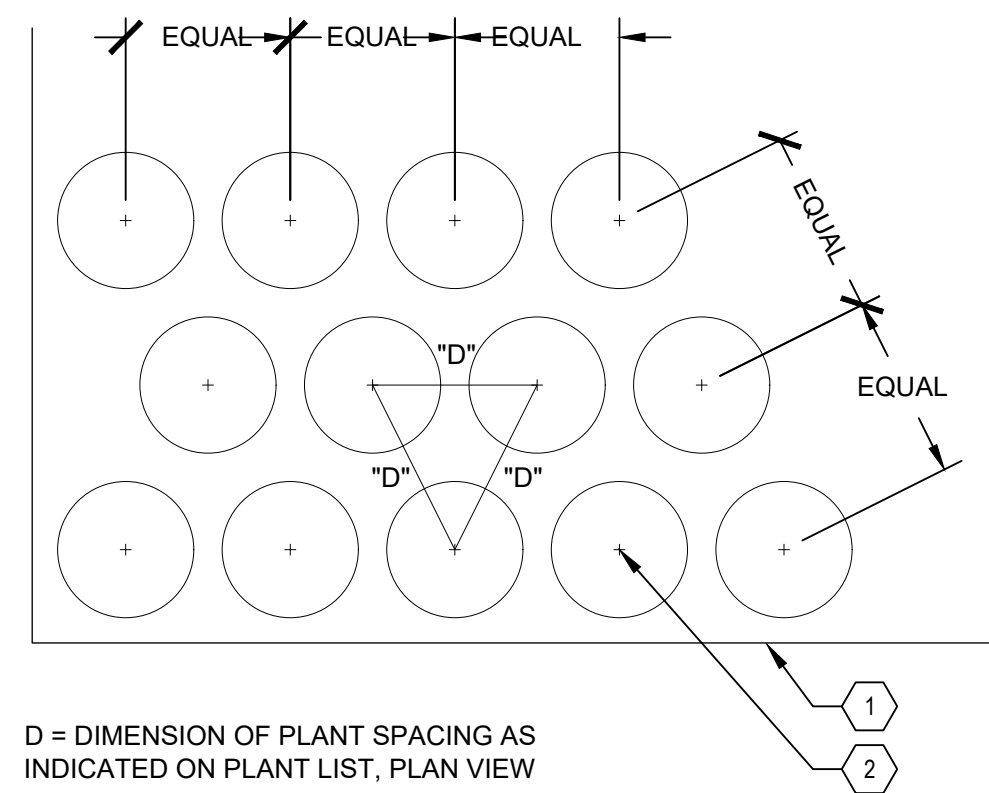

D TYPICAL PLANT SPACING
 SCALE: NTS

- NOTES:
- SET FINISH GRADE OF PLANTING AREA 2" BELOW FINISH SURFACE OF PAVING, CURB, OR HEADER
 - SEE PLANTING SCHEDULE FOR SPACING OF ALL SHRUBS AND GROUNDCOVERS
 - ALL SHRUBS / GROUNDCOVER TO BE PLANTED AT EQUAL SPACING (TRIANGULAR) UNLESS OTHERWISE INDICATED ON PLANS.
 - TO DETERMINE APPROPRIATE PLANT QUANTITIES REFER TO THE PLANTING SCHEDULE OR PLAN.

KEYED LEGEND

- 1 EDGE OF ADJACENT PAVEMENT
- 2 SHRUB, PERENNIAL OR ORNAMENTAL GRASS PLANT CENTER LOCATION

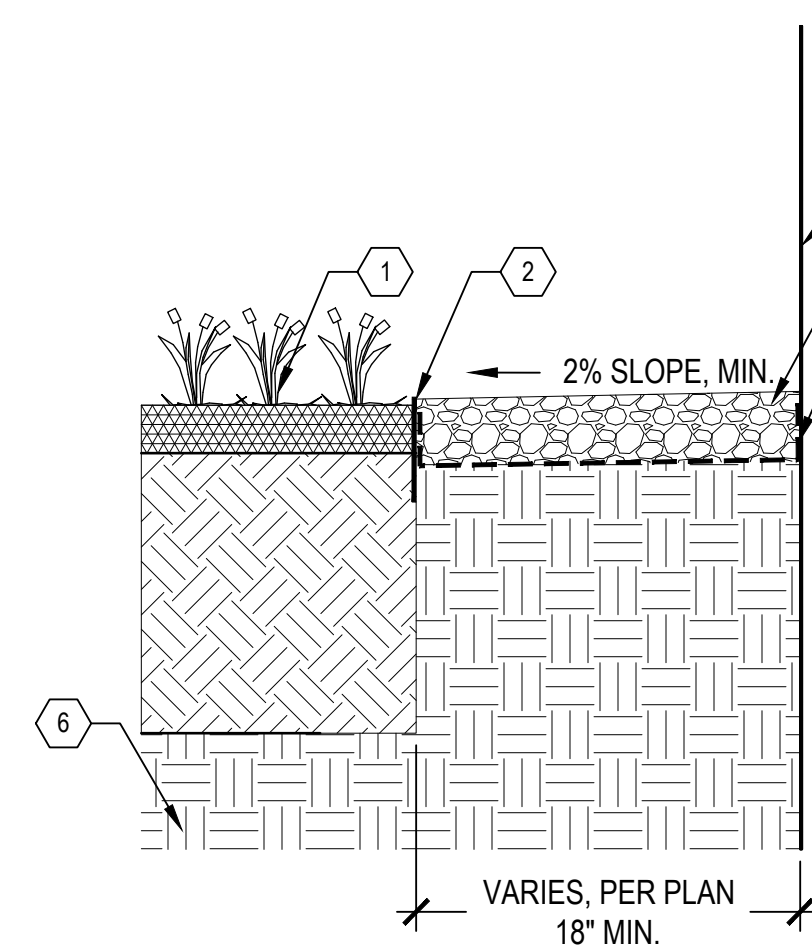

E STONE MAINTENANCE EDGE
 SCALE: NTS

KEYED LEGEND

- 1 ADJACENT PLANTING BED
- 2 BLACK ANODIZED ALUMINUM EDGING
- 3 BUILDING FACE
- 4 3" DEPTH STONE MULCH
- 5 WOVEN GEOTEXTILE FILTER FABRIC, WRAP UP SIDES OF BUILDING AND EDGING
- 6 PREPARED SUBGRADE

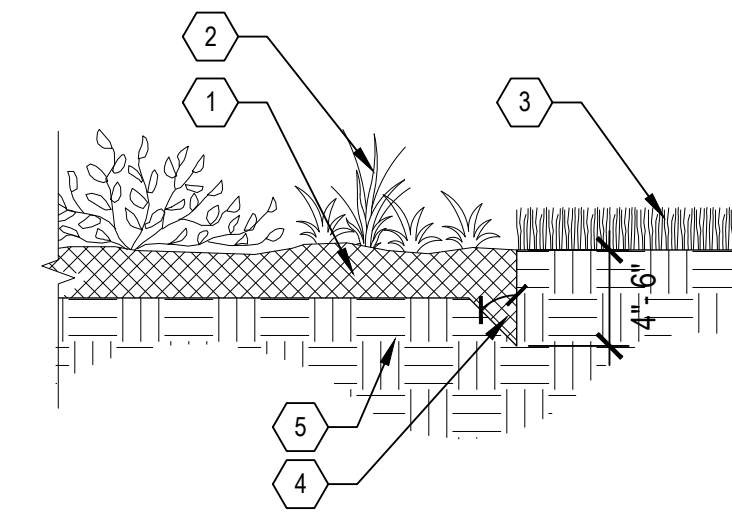

F SHOVEL CUT EDGE
 SCALE: NTS

KEYED LEGEND

- 1 3" DEPTH OF MULCH LAYER
- 2 SHRUB PLANTING BED
- 3 LAWN ADJACENT TO PLANTING BED
- 4 45 DEGREE ANGLE SHOVEL CUT EDGE TOWARD PLANTING BED
- 5 COMPACTED SUBGRADE

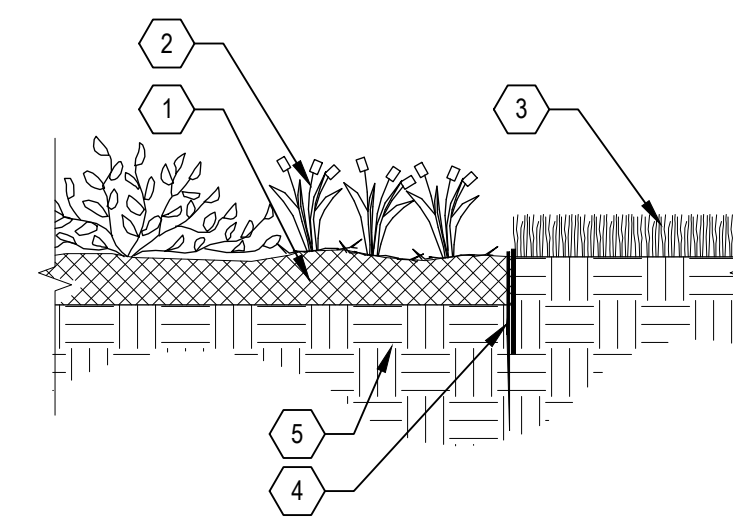

G TURF METAL EDGE
 SCALE: NTS

KEYED LEGEND

- 1 3" DEPTH OF MULCH LAYER
- 2 SHRUB PLANTING BED
- 3 LAWN ADJACENT TO PLANTING BED
- 4 BLACK ANODIZED ALUMINUM EDGING
- 5 COMPACTED SUBGRADE

- 1 BIOFILTRATION BASIN PERENNIAL PLUGS (SEE PERENNIAL PLUGS PLANT LIST)
- 2 STRAW MULCH

PERENNIAL PLUG SPACING
1 PLUG PER 2.25 SQUARE FEET
(18" SPACING O.C.)
PLANT IN CLUSTERS OF 5-12 PLANTS PER SPECIES

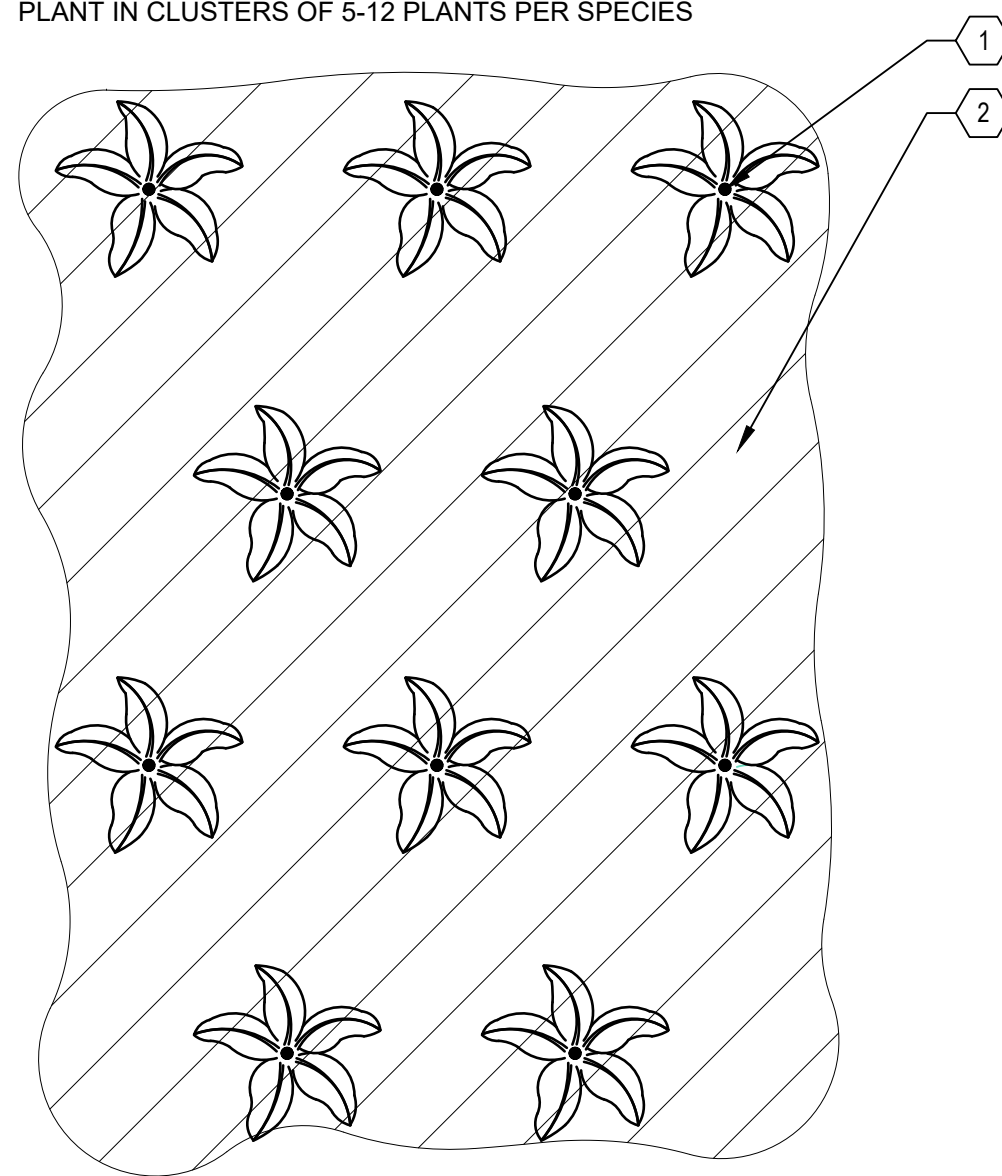

PLAN VIEW

PLANT BIOFILTRATION BASIN PLUGS
SCALE: NTS

INSTALL PERENNIALS AND GRASSES PER PLAN. AFTER INSTALLING EROSION CONTROL FABRIC, CUT A SMALL OPENING THE SIZE OF THE ROOT BALL. MASS IN THE EROSION CONTROL FABRIC TO PLANT EACH INDIVIDUAL PLANT.

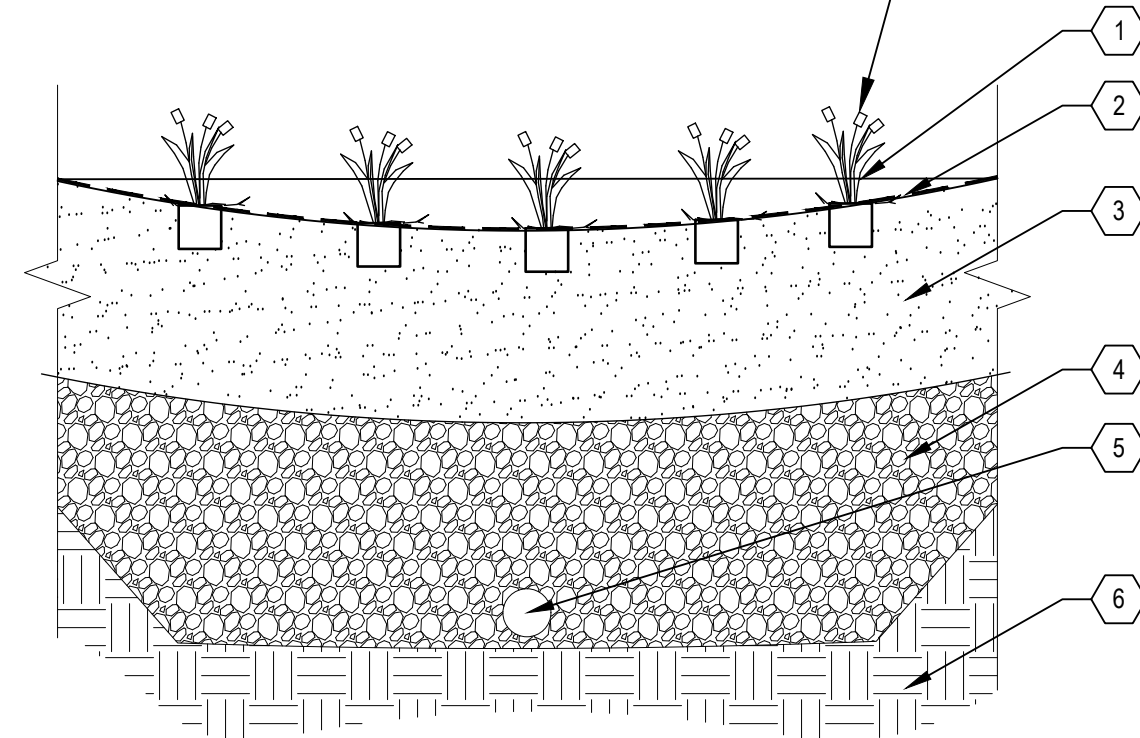

SECTION VIEW

- 1 BIOFILTRATION BASIN PLANTING (SEE PERENNIAL PLUGS PLANT LIST)
- 2 BIODEGRADABLE EROSION CONTROL MATTING ON BOTTOM AND SLOPES OF BASIN
- 3 ENGINEERED SOIL MIX - SEE CIVIL FOR DEPTH
- 4 STONE STORAGE LAYER - SEE CIVIL FOR DEPTH
- 5 PVC DRAIN TILE, SEE CIVIL PLAN.
- 6 PREPARED SUBGRADE

PERENNIAL PLUGS PLANT LIST

Botanical Name	Common Name	Quantity	Size	Comments
<i>Asclepias incarnata</i>	Marsh Milkweed	160.00	Round Tapered Plug	18" O.C. in clusters of 5-12 plants per species
<i>Aster Novae-angliae</i>	New England Aster	224.00	Round Tapered Plug	18" O.C. in clusters of 5-12 plants per species
<i>Carex stipitata</i>	Common Fox Sedge	160.00	Round Tapered Plug	18" O.C. in clusters of 5-12 plants per species
<i>Carex vulpinoidea</i>	Brown Fox Sedge	224.00	Round Tapered Plug	18" O.C. in clusters of 5-12 plants per species
<i>Eupatorium maculatum</i>	Spotted Joe Pye Weed	224.00	Round Tapered Plug	18" O.C. in clusters of 5-12 plants per species
<i>Helenium autumnale</i>	Sneezeweed	224.00	Round Tapered Plug	18" O.C. in clusters of 5-12 plants per species
<i>Liatris spicata</i>	Marsh Blazingstar	224.00	Round Tapered Plug	18" O.C. in clusters of 5-12 plants per species
<i>Lobelia cardinalis</i>	Cardinal Flower	224.00	Round Tapered Plug	18" O.C. in clusters of 5-12 plants per species
<i>Monarda fistulosa</i>	Wild Bergamot	224.00	Round Tapered Plug	18" O.C. in clusters of 5-12 plants per species
<i>Panicum virgatum</i>	Switchgrass	224.00	Round Tapered Plug	18" O.C. in clusters of 5-12 plants per species
<i>Ratibida pinnata</i>	Yellow Coneflower	224.00	Round Tapered Plug	18" O.C. in clusters of 5-12 plants per species
<i>Rudbeckia hirta</i>	Black-Eyed Susan	224.00	Round Tapered Plug	18" O.C. in clusters of 5-12 plants per species
<i>Scirpus atrovirens</i>	Dark-Green Bulrush	224.00	Round Tapered Plug	18" O.C. in clusters of 5-12 plants per species
<i>Scirpus cyperinus</i>	Wool Grass	224.00	Round Tapered Plug	18" O.C. in clusters of 5-12 plants per species
<i>Spartina pectinata</i>	Prairie Cordgrass	224.00	Round Tapered Plug	18" O.C. in clusters of 5-12 plants per species
<i>Tradescantia ohioensis</i>	Ohio Spiderwort	224.00	Round Tapered Plug	18" O.C. in clusters of 5-12 plants per species
<i>Verbena hastata</i>	Blue Vervain	160.00	Round Tapered Plug	18" O.C. in clusters of 5-12 plants per species
<i>Vernonia fasciculata</i>	Ironweed	160.00	Round Tapered Plug	18" O.C. in clusters of 5-12 plants per species

RAINWATER RENEWAL SEED MIX
(SIDE SLOPES OF BIOFILTRATION BASINS)

Botanical Name	Common Name	PLS Ounces/Acre
Wildflower Forbs:		
<i>Asclepias incarnata</i>	Marsh (Red) Milkweed	3.00
<i>Aster ericoides</i>	Heath Aster	0.10
<i>Aster novae-angliae</i>	New England Aster	1.50
<i>Baptisia leucantha (alba)</i>	White Wild Indigo	4.00
<i>Eupatorium maculatum</i>	Spotted Joe Pye Weed	0.80
<i>Eupatorium perfoliatum</i>	Boneset	0.50
<i>Liatris pycnostachya</i>	Prairie Blazing Star	2.50
<i>Liatris spicata</i>	Marsh Blazing Star	5.00
<i>Lobelia cardinalis</i>	Cardinal Flower	0.25
<i>Lobelia siphilitica</i>	Great Blue Lobelia	0.50
<i>Monarda fistulosa</i>	Wild Bergamot	1.50
<i>Physostegia virginiana</i>	Obedient Plant	1.50
<i>Pycnanthemum virginianum</i>	Mountain Mint	0.30
<i>Ratibida pinnata</i>	Yellow Coneflower	2.25
<i>Rudbeckia hirta</i>	Black-Eyed Susan	2.00
<i>Rudbeckia subtomentosa</i>	Sweet Black-Eyed Susan	2.00
<i>Solidago ohioensis</i>	Ohio Goldenrod	0.50
<i>Tradescantia ohioensis</i>	Ohio Spiderwort	1.25
<i>Verbena hastata</i>	Blue Vervain	1.00
<i>Vernonia fasciculata</i>	Ironweed	1.00
		Totals = 31.45
Perennial Grasses, Sedges & Rushes:		
<i>Bromus ciliatus</i>	Fringed Brome	20.00
<i>Calamagrostis canadensis</i>	Blue Joint Grass	1.00
<i>Carex bebbii</i>	Bebb's Oval Sedge	2.00
<i>Carex crawfordii</i>	Crawford's Sedge	1.00
<i>Carex crinita</i>	Fringed Sedge	0.75
<i>Carex stipitata</i>	Common Fox Sedge	1.50
<i>Carex vulpinoidea</i>	Brown Fox Sedge	1.00
<i>Elymus canadensis</i>	Canada Wild Rye	24.00
<i>Elymus virginicus</i>	Virginia Wild Rye	32.00
<i>Glyceria grandis</i>	Reed Manna Grass	1.00
<i>Panicum virgatum</i>	Switchgrass	3.50
<i>Scirpus atrovirens</i>	Dark-Green Bulrush	0.50
<i>Scirpus cyperinus</i>	Wool Grass	0.30
<i>Sorghastrum nutans</i>	Indian Grass	5.00
<i>Spartina pectinata</i>	Prairie Cordgrass	3.00
		Totals = 96.55

TURF SEED MIX

Reinder's Deluxe 50 Seed Mix	Seed at rate of 150-200 lbs/acre
20% Kentucky Bluegrass	
15% Newport Kentucky Bluegrass	
15% Ken Blue Kentucky Bluegrass	
25% Creeping Red Fescue	
15% Quebec Perennial Ryegrass	
10% Fiesta III Perennial Ryegrass	

NO MOW SEED MIX

Reinder's No Mow/Low Grow Mix	Seed at rate of 175-250 lbs/acre
45% Spartan II Hard Fescue	
40% Quatro Sheep Fescue	
15% Turf Type Annual Ryegrass	

UPLAND MEADOW SEED MIX

Botanical Name	Common Name	PLS Ounces/Acre
Wildflower Forbs:		
<i>Achillea millefolium</i>	Native Yarrow	0.75
<i>Agastache foeniculum</i>	Lavender Hyssop	0.50
<i>Amorpha canescens</i>	Leadplant	2.00
<i>Asclepias syriaca</i>	Common Milkweed	2.00
<i>Chamaecrista fasciculata</i>	Partridge Pea	8.00
<i>Careopsis palmata</i>	Prairie Coreopsis	2.00
<i>Dalea candida</i>	White Prairie Clover	2.50
<i>Dalea purpurea</i>	Purple Prairie Clover	2.00
<i>Echinacea purpurea</i>	Purple Coneflower	8.00
<i>Heliopsis helianthoides</i>	Early Sunflower	4.00
<i>Liatris pycnostachya</i>	Prairie Blazing Star	1.50
<i>Monarda fistulosa</i>	Wild Bergamot	0.50
<i>Monarda punctata</i>	Dotted Mint	1.00
<i>Ratibida pinnata</i>	Yellow Coneflower	6.00
<i>Rosa arkansana</i>	Prairie Wild Rose	2.00
<i>Rudbeckia hirta</i>	Black-Eyed Susan	2.00
<i>Solidago speciosa</i>	Showy Goldenrod	0.50
<i>Tradescantia ohioensis</i>	Ohio Spiderwort	4.00
<i>Verbena stricta</i>	Hoary Vervain	1.50
<i>Zizia aptera</i>	Heart-Leaved Golden Alexanders	1.00
		Totals = 51.75
Perennial Grasses, Sedges & Rushes:		
<i>Bouteloua curtipendula</i>	Side Oats Grama	40.00
<i>Bouteloua gracilis</i>	Blue Grama	4.00
<i>Elymus canadensis</i>	Canada Wild Rye	16.00
<i>Juncus tenuis</i>	Path Rush	0.25
<i>Koeleria cristata</i>	June Grass	4.00
<i>Schizachyrium scoparium</i>	Little Bluestem	16.00
<i>Sorghastrum nutans</i>	Indian Grass	4.00
<i>Sporobolus heterolepis</i>	Prairie Dropseed	8.00
		Totals = 92.25

POTHS GENERAL DEVELOPMENT
76TH AND RAWSON
FRANKLIN, WI 53132
LANDSCAPE DETAILS

PRELIMINARY
NOT FOR
CONSTRUCTION

ISSUANCE DATE

NO. REVISION DATE

SCALE: 1" = 60'
PROJECT NO: 21775
DESIGN DATE: ---
PLOT DATE: 2023.10.13
DRAWN BY: MRG
CHECKED BY: JL
APPROVED BY: CTC

SHEET NO:

L201

PLANTING QUALITY ASSURANCE

- 1. PLANTS ARE TO BE INSPECTED UPON DELIVERY TO PROJECT SITE AND THE LANDSCAPE ARCHITECT OR OWNER'S PROJECT REPRESENTATIVE MAY REJECT ANY SPECIMENS NO LONGER MEETING THE SPECIFIED STANDARDS OR THAT HAVE BEEN DAMAGED IN TRANSIT.
2. ALL PLANT MATERIAL SHALL BE TRUE TO SPECIES AND VARIETY/HYBRID/CULTIVAR SPECIFIED, AND NURSERY GROWN IN ACCORDANCE WITH GOOD HORTICULTURAL PRACTICES...
3. TREES:
3.1. SHALL BE TRAINED IN DEVELOPMENT AND APPEARANCE AS TO BE SUPERIOR IN FORM, COMPACTNESS AND SYMMETRY...
3.2. WITH A DAMAGED, CUT OR CROOKED LEADER, ABRASION OF BARK, SUNSCALD, FROST CRACK, DISFIGURING KNOTS, INSECTS (INCLUDING EGGS AND LARVAE) OR INSECT DAMAGE...
3.3. SHALL HAVE HEALTHY, WELL-DEVELOPED ROOT SYSTEMS, AND BE FREE FROM PHYSICAL DAMAGE OR OTHER HINDERANCES TO HEALTHY GROWTH...
3.4. BALLED AND BURLAPPED PLANTS SHALL BE DUG WITH SOLID BALLS OF A DIAMETER NOT LESS THAN THAT RECOMMENDED BY THE AMERICAN STANDARDS FOR NURSERY STOCK...
4. PLANTS SHALL CONFORM TO THE MEASUREMENTS SPECIFIED WITHIN THE PLANT SCHEDULE.

PLANTING PROJECT CONDITIONS:

- 1. VERIFY SERVICE AND UTILITY LOCATIONS, AND DIMENSIONS OF CONSTRUCTION CONTIGUOUS WITH NEW PLANTINGS BY FIELD MEASUREMENTS BEFORE PROCEEDING WITH PLANTING WORK.
2. INTERRUPTION OF EXISTING SERVICES OR UTILITIES; DO NOT INTERRUPT SERVICES OR UTILITIES UNLESS PERMITTED UNDER THE FOLLOWING CONDITIONS AND THEN ONLY AFTER ARRANGING TO PROVIDE TEMPORARY SERVICES OR UTILITIES ACCORDING TO REQUIREMENTS INDICATED:
2.1. NOTIFY OWNER'S PROJECT REPRESENTATIVE NO FEWER THAN TWO DAYS IN ADVANCE OF PROPOSED INTERRUPTION OF EACH SERVICE OR UTILITY.
2.2. DO NOT PROCEED WITH INTERRUPTION OF SERVICES OR UTILITIES WITHOUT REPRESENTATIVE'S WRITTEN PERMISSION.
3. PLANTING RESTRICTIONS: PLANTING SHALL OCCUR DURING THE FOLLOWING ACCEPTABLE INSTALLATION PERIODS:
3.1. DECIDUOUS TREES AND SHRUBS - APRIL 15 TO OCTOBER 15.
3.2. NATIVE SEEDING AND TURFGRASS: APRIL 15 - OCTOBER 15
4. WEATHER LIMITATIONS: PROCEED WITH PLANTING ONLY WHEN EXISTING AND FORECASTED WEATHER CONDITIONS PERMIT PLANTING TO BE PERFORMED WHEN BENEFICIAL AND OPTIMUM RESULTS MAY BE OBTAINED.
5. CONTRACTOR SHALL PROTECT ALL EXISTING AND/OR NEWLY INSTALLED PLANTS, LAWNS, AND GRASS AREAS FROM DAMAGE AT ALL TIMES...
6. EXAMINE AREAS TO RECEIVE PLANTS FOR COMPLIANCE WITH REQUIREMENTS AND CONDITIONS AFFECTING INSTALLATION AND PERFORMANCE...
6.1. VERIFY THAT NO FOREIGN OR DELETERIOUS MATERIAL OR LIQUID SUCH AS PAINT, PAINT WASHOUT, CONCRETE, DRYING WIND BURN, SWEATING, WHIPPING, AND OTHER HANDLING AND TYING DAMAGE...
6.2. DO NOT MIX OR PLACE SOILS IN FROZEN, WET, OR MUDDY CONDITIONS.

PLANTING DELIVERY, STORAGE, & HANDLING:

- 1. BULK MATERIALS;
1.1. DO NOT DUMP OR STORE BULK MATERIALS NEAR STRUCTURES, UTILITIES, WALKWAYS AND PAVEMENTS, OR ON EXISTING TURF AREAS OR PLANTS.
2. DO NOT PRUNE TREES AND SHRUBS BEFORE DELIVERY. PROTECT BARK, BRANCHES, AND ROOT SYSTEMS FROM SUNSCALD, DRYING, WIND BURN, SWEATING, WHIPPING, AND OTHER HANDLING AND TYING DAMAGE...
3. HANDLE PLANTING STOCK BY ROOT BALL.
4. DELIVER PLANTS AFTER PREPARATIONS FOR PLANTING HAVE BEEN COMPLETED AND INSTALL IMMEDIATELY...
4.1. SET BALLED STOCK ON GROUND AND COVER BALL WITH SOIL, PEAT MOSS, SAWDUST, OR OTHER ACCEPTABLE MATERIAL.
4.2. WATER ROOT SYSTEMS OF PLANTS STORED ON-SITE DEEPLY AND THOROUGHLY WITH A FINE-MIST SPRAY...
5. EXCAVATION FOR TREES & SHRUBS
5.1. EXCAVATE CIRCULAR PLANTING PITS AS INDICATED IN DRAWINGS...
5.2. DO NOT EXCAVATE DEEPER THAN DEPTH OF THE ROOT BALL...
5.3. IF AREA UNDER THE PLANT WAS INITIALLY DUG TOO DEEP...
5.4. MAINTAIN REQUIRED ANGLES OF REPOSE OF ADJACENT MATERIALS...
5.5. MAINTAIN SUPERVISION OF EXCAVATIONS DURING WORKING HOURS...
5.6. KEEP EXCAVATIONS COVERED OR OTHERWISE PROTECTED...
6. SUBSOIL AND TOPSOIL REMOVED FROM EXCAVATIONS MAY BE USED AS PLANTING SOIL...
7. NOTIFY OWNER'S PROJECT REPRESENTATIVE IF UNEXPECTED ROCK OR OBSTRUCTIONS DETRIMENTAL TO TREES OR SHRUBS ARE ENCOUNTERED...
8. NOTIFY OWNER'S PROJECT REPRESENTATIVE IF SUBSOIL CONDITIONS EVIDENCE UNEXPECTED WATER SEEPAGE OR RETENTION IN TREE OR SHRUB PLANTING PITS.

TREE & SHRUB PLANTING

- 1. BEFORE PLANTING VERIFY THAT ROOT FLARE IS VISIBLE AT TOP OF ROOT BALL. IF ROOT FLARE IS NOT VISIBLE, REMOVE SOIL IN A LEVEL MANNER FROM THE ROOT BALL TO WHERE THE TOP-MOST ROOT EMERGES FROM THE TRUNK...
2. PLANTS FOUND TO HAVE STEM GIRDLING ROOTS AND/OR KINKED ROOTS AT THE TIME OF PLANTING WILL BE REJECTED AND REPLACEMENTS SHALL BE PROVIDED AT NO ADDITIONAL COST TO THE OWNER.
3. REMOVE ALL TWINE, STRING, WIRE, AND ALL OTHER NON-BIODEGRADABLE MATERIAL ENTIRELY FROM ROOT BALL AREA.
4. REMOVE ONLY DEAD, DYING, OR BROKEN BRANCHES. DO NOT PRUNE FOR SHAPE. DO CUT TREE LEADERS.
5. SET BALLED AND BURLAPPED STOCK PLUMB AND IN CENTER OF PLANTING PIT OR TRENCH WITH ROOT FLARE 2 INCHES ABOVE ADJACENT FINISH GRADES.
5.1. USE SOIL MATERIALS FROM EXCAVATION FOR BACKFILL.
5.2. CAREFULLY CUT AND REMOVE BURLAP, ROPE, AND WIRE BASKETS FROM THE ENTIRE ROOT BALL...
5.3. BACKFILL AROUND ROOT BALL IN LAYERS...
5.4. CONTINUE BACKFILLING PROCESS. WATER AGAIN AFTER PLACING AND TAMPING FINAL LAYER OF SOIL.

TREE & SHRUB MATERIAL:

- 1. GENERAL: FURNISH NURSERY-GROWN PLANTS TRUE TO GENUS, SPECIES, VARIETY, CULTIVAR, STEM FORM, SHEARING, AND OTHER FEATURES INDICATED IN PLANT SCHEDULE...
1.1. TREES WITH DAMAGED, CROOKED, OR MULTIPLE LEADERS...
1.2. COLLECTED STOCK: DO NOT USE PLANTS HARVESTED FROM THE WILD...
1.3. PLANT MATERIAL SHALL BE PROVIDED IN THE CONTAINER TYPE INDICATED IN THE DRAWINGS...
2. FURNISH TREES WITH ROOT BALLS MEASURED FROM TOP OF ROOT BALL...
3. SELECT STOCK FOR UNIFORM HEIGHT AND SPREAD.

PLANTING SOIL:

- PLANTING SOIL SHALL BE PLACED IN ONE CONTINUOUS VOLUME FOR THE WIDTH OF LANDSCAPE AREAS, AND A MINIMUM OF 3X THE DIAMETER OF THE ROOT BALL LENGTHWISE
1. INSTALL PLANTING SOIL FOR PLANT BEDS IN 6" LIFTS, MINIMUM 8" DEPTH.
2. DO NOT APPLY PLANTING SOIL TO SATURATED OR FROZEN SUBGRADES.
3. PLANTING SOIL SHALL BE A MIX OF 6-PARTS TOPSOIL, 1-PART COMPOST...
3.1. THE PROJECT WILL ACCEPT ONLY CLEAN, SALVAGED OR IMPORTED TOPSOIL...
3.2. STRIPPED, SALVAGED, OR MINED TOPSOIL MUST BE TAKEN FROM THE TOP 6-INCHES OF THE A-HORIZON...
4. INSTALL METAL EDGE IN ACCORDANCE WITH MANUFACTURER'S WRITTEN INSTRUCTIONS.
5. ENSURE THAT METAL EDGING IS PROPERLY INSTALLED AND SECURED BEFORE INSTALLING STONE MULCH.

METAL EDGING

- 1. STANDARD PROFILE, COMMERCIAL-GRADE, EXTRUDED ALUMINUM EDGING, FABRICATED IN STANDARD LENGTHS WITH INTERLOCKING SECTIONS WITH LOOPS STAMPED FROM FACE OF SECTIONS TO RECEIVE STAKES.
1.1. BASIS OF DESIGN: CLEANLINE XL BY PERMALOC OR APPROVED EQUAL.
1.2. EDGING SIZE: 3/16-INCH-WIDE BY 5 INCHES DEEP.
1.3. STAKES: ALUMINUM, ASTM 221, ALLOY 6061-T6, 18-INCHES LONG.
1.4. FINISH: MILL (NATURAL ALUMINUM)
1.5. MANUFACTURERS: SUBJECT TO COMPLIANCE WITH REQUIREMENTS, AVAILABLE MANUFACTURERS OFFERING PRODUCTS THAT MAY BE INCORPORATED INTO THE WORK...
2. INSTALL METAL EDGE IN ACCORDANCE WITH MANUFACTURER'S WRITTEN INSTRUCTIONS.
3. ENSURE THAT METAL EDGING IS PROPERLY INSTALLED AND SECURED BEFORE INSTALLING STONE MULCH.

STONE MULCH MATERIAL & INSTALLATION:

- 1. SHALL BE HARD, DURABLE, STONE, WASHED FREE OF LOAM, SAND, CLAY, AND OTHER FOREIGN SUBSTANCES...
1.1. MATERIAL: ANGULAR WASHED STONE.
1.2. SIZE: 1-1/2" DIAMETER
1.3. DEPTH: 3" MINIMUM DEPTH PLACED IN ONE LIFT
1.4. COLOR RANGE: BLEND OF DARK GREY & BLUE TONES
1.5. BASIS OF DESIGN: 1-1/2" 'AMERICAN HERITAGE' AGGREGATE BY COUNTY MATERIALS.
2. LIGHTLY COMPACT AREAS TO RECEIVE STONE MULCH
3. INSTALL WEED BARRIER FABRIC IN ACCORDANCE WITH MANUFACTURER'S WRITTEN INSTRUCTIONS...
4. PLACE AND FINISH STONE MULCH AS INDICATED IN DRAWINGS, ENSURING A SMOOTH, LEVEL TOP SURFACE FOR ALL STONE MULCH AREAS HELD APPROXIMATELY 1/2" BELOW THE TOP SURFACE OF ADJACENT PAVED AREAS OR METAL EDGING.

BARK MULCH MATERIAL & INSTALLATION

- 1. TWICE-SHREDDED HARDWOOD BARK MULCH TO BE PROVIDED AS TOP-DRESSING FOR ALL AT-GRADE PLANTING BEDS...
1.1. SIZE RANGE: MAXIMUM 2.5" TO 3"
1.2. COLOR: NATURAL, UN-DYED
1.3. PROVIDE 3" DEPTH MULCH FOR ALL PLANTING BEDS...
2. KEEP BARK MULCH 2" CLEAR OF ALL STEMS OF PLANT MATERIAL.

TURF SEEDING:

- 1. DELIVERY:
1.1. DELIVER PACKAGED SEED MATERIALS IN ORIGINAL, UNOPENED CONTAINERS...
2. PROJECT CONDITIONS:
2.1. SEED DURING ONE OF THE FOLLOWING PERIODS.
2.1.1. SPRING SEEDING SEASON: APRIL 1 TO JUNE 15.
2.1.2. FALL SEEDING SEASON: AUGUST 15 TO OCTOBER 1.
3. PRODUCTS
3.0.1. PROVIDE THE FOLLOWING FOR TURFGRASS SEED BASIS OF DESIGN...
3.0.2. TURFGRASS SEED MIX TO BE FERTILIZED WITH 'SCOTT'S STARTER FERTILIZER'...
4. PROCEED WITH INSTALLATION ONLY AFTER UNSATISFACTORY CONDITIONS HAVE BEEN MET.
5. REMOVE ANY AND ALL UNDESIRABLE VEGETATION THAT HAS GERMINATED...
5.1. DO NOT APPLY SEED UNTIL FIVE TO SEVEN DAYS AFTER LAST HERBICIDE TREATMENT.
6. FINISH GRADING: GRADE AREAS TO A SMOOTH, UNIFORM SURFACE...
7. MOISTEN PREPARED AREA BEFORE SEEDING IF SOIL IS DRY...
8. NO SEEDING SHALL OCCUR ON FROZEN GROUND...
9. SEEDING RATES TO BE PERFORMED IN ACCORDANCE WITH SEED SUPPLIER RECOMMENDATIONS.

NATIVE SEEDING:

- 1. PROVIDE THE FOLLOWING SEED TYPES FROM: AGRECOL LLC 10101 N. CASEY ROAD EVANSVILLE, WISCONSIN 53536:
1.1. AGRECOL'S 'XXXXXX' MIX FOR AREAS SHOWN AS 'XXXXXXXX SEED MIX'
1.2. AGRECOL'S 'XXXXXX' SEED MIX FOR AREAS SHOWN AS 'XXXXXXXXXX SEED MIX'
1.3. REFER TO DETAIL XXXXXX ON SHEET L2XX, FOR SEED MIX COMPOSITION.
2. REFER TO CIVIL PLANS FOR LOCATIONS AND EXTENTS OF EROSION CONTROL MAT...
3. WITHIN 4 WEEKS FOLLOWING THE ISSUANCE OF THE NOTICE TO PROCEED...
4. ALL SEED MATERIAL SHALL ORIGINATE FROM LOCAL SOURCES...
5. ALL SEEDING ZONE BOUNDARIES SHALL BE SURVEYED AND STAKED...
6. THE LANDSCAPE ARCHITECT RESERVES THE RIGHT TO ADJUST SEED LIMITS...
7. COORDINATION IS REQUIRED TO ENSURE RAINFALL/GROUNDWATER SEEPAGE DOES NOT RESULT IN SOIL MOISTURE CONDITIONS THAT WILL CAUSE EXCESSIVE RUTTING...
8. WHERE SEEDING OCCURS IN CLOSE PROXIMITY TO OTHER SITE IMPROVEMENTS...
9. FOLLOWING NATIVE SEED MIX INSTALLATION, THE LANDSCAPE ARCHITECT AND CONTRACTOR SHALL CONDUCT A SUBSTANTIAL COMPLETION INSPECTION...
10. GENERAL INSTALLATION:
10.1. SEEDING OF NATIVE SEED MIXES SHALL OCCUR IN THE EARLY SPRING:
10.1.1. APRIL 15 THROUGH MAY 31.
10.2. DO NOT SOW SEED DURING ADVERSE WEATHER...
10.3. DO NOT SOW SEED IN AREAS WHERE STANDING WATER IS PRESENT.
11. GRADE PREPARATION:
11.1. SUBGRADE AND FINISH GRADE PREPARATION SHALL BE IN ACCORDANCE...
11.2. PRIOR TO SEEDING, REPAIR ANY RUTS, RILLS, OR GULLIES...
11.3. IF THE PREPARED GRADE IS ERODED OR COMPACTED...
11.4. IMMEDIATELY BEFORE SEEDING, SCARIFY, LOOSEN, FLOAT, AND DRAG TOPSOIL...
11.5. NO FURTHER GRADE PREPARATION IS REQUIRED.
12. IF REQUIRED DUE TO CONSTRUCTION SEQUENCING, SEED THE SITE WITH A TEMPORARY COVER CROP...
12.1. IF SEEDING MAY 15 THROUGH SEPTEMBER 1: MIX OF 32 POUNDS PER ACRE...
12.2. IF SEEDING SEPTEMBER 1 THROUGH OCTOBER 15: 20 POUNDS PER ACRE...
13. BROADCASTING:
13.1. FOR SPRING SEEDING OF NATIVE SEED, SOW SEED DIRECTLY ONTO BARE GROUND...
13.2. INCREASE THE VOLUME OF THE BROADCASTED SEED MIX...
13.2.1. USE HALF OF THE TOTAL SEED QUANTITY AND CROSS THE ENTIRE AREA...
13.2.2. LIGHT SEEDS, AWNED SEEDS, OR BEARDED SEEDS TEND TO RISE TO THE TOP...
13.2.3. RAKE OR DRAG THE SEED INTO THE SOIL...
14. DRILL SEEDER OR DROP SEEDER/SPREADER:
14.1. FOR SPRING DRILL SEEDING, SOW SEED DIRECTLY ONTO BARE GROUND...
14.2. CHECK THE EQUIPMENT FREQUENTLY TO ENSURE THE SEED IS DISPERSING...
14.3. IF THE EQUIPMENT IS NOT EQUIPPED WITH A ROLLER...
14.3.1. DO NOT MIX THE NATIVE SEED WITH ANY CARRIER MATERIAL.
14.3.2. EVENLY DISTRIBUTE THE SEED ACROSS THE ENTIRE SITE...
14.4. KEEP THE TOPSOIL MOIST (TO A DEPTH OF 3 INCHES) FOR 3-6 WEEKS...
14.5. AFTERWARD, APPLY ONE INCH OF WATER DURING THE GROWING SEASON...
14.6. KEEP THE TOPSOIL MOIST (TO A DEPTH OF 3 INCHES) FOR 3-6 WEEKS...
14.7. AFTERWARD, APPLY ONE INCH OF WATER DURING THE GROWING SEASON...
14.8. KEEP THE TOPSOIL MOIST (TO A DEPTH OF 3 INCHES) FOR 3-6 WEEKS...
14.9. AFTERWARD, APPLY ONE INCH OF WATER DURING THE GROWING SEASON...

- 15. ALL AREAS OVER WHICH HAULING OPERATIONS HAVE BEEN CONDUCTED SHALL BE KEPT CLEAN ON A DAILY BASIS. PROMPTLY REMOVE ALL MATERIALS SPILLED ON PAVEMENT.
16. UPON COMPLETION OF SEED INSTALLATION, REMOVE FROM THE SITE AND LEGALLY DISPOSE OF ALL TRASH AND DEBRIS INCLUDING ANY MATERIAL REMOVED DURING GRADE PREPARATION.
17. RESTORE ANY EXISTING AREAS DAMAGED BY OPERATIONS UNDER THE CONTRACT...
18. ANY DAMAGE BY THE CONTRACTOR TO ESTABLISHED OR NEWLY SEEDED AREAS NOT WITHIN THE PROJECT SCOPE OF WORK SHALL BE REPAIRED AND RESEED AT NO COST TO THE OWNER.

CLEAN-UP AND PROTECTION

- 1. DURING PLANTING, KEEP ADJACENT PAVING AND CONSTRUCTION CLEAN AND WORK AREA IN AN ORDERLY CONDITION.
2. PROTECT PLANTS FROM DAMAGE DUE TO LANDSCAPE OPERATIONS...
3. AFTER INSTALLATION REMOVE ALL NURSERY TAGS, NURSERY STAKES, TIE TAPE, LABELS, WIRE, STRING, AND OTHER DEBRIS FROM PLANT MATERIAL, PLANTING AREAS, AND PROJECT SITE.

VEGETATION MONITORING AND MANAGEMENT

MANAGEMENT AND MONITORING: THE MANAGEMENT AND MONITORING OF NATIVE PLANTINGS (INCLUDING SEED MIXES, FORBS AND PLUGS) SHOULD BE DIRECTED TOWARD THE GOAL OF CREATING A STABLE, NATIVE PLANT COMMUNITY...
UNDESIRABLE PLANT CONTROL: OVERALL MANAGEMENT OF VEGETATED AREAS MAY INCLUDE, BUT ARE NOT LIMITED TO: RESEEDING OR REPLANTING DAMAGED OR NON-ACTIVE GROWTH AREAS...
SHORT-TERM VEGETATION MANAGEMENT: SHORT-TERM VEGETATION MANAGEMENT (MAINTENANCE PERIOD AFTER SEEDING/PLUG INSTALLATION) OCCURS WHILE THE LANDSCAPE CONTRACTOR OR SPECIALTY SEEDING/RESTORATION CONTRACTOR IS RESPONSIBLE TO THE PROJECT OWNER...

INSPECTIONS SHOULD BE MADE FREQUENTLY DURING THE GROWING SEASON TO PROPERLY DOCUMENT ANY INVASIVE SPECIES, WEEDS, DEHYDRATION, DAMAGE, EROSION, DISEASES, BARE AREAS, AND PESTS...
LONG TERM VEGETATION MANAGEMENT: LONG-TERM MANAGEMENT (AFTER MAINTENANCE AGREEMENT ENDS) WILL BE THE RESPONSIBILITY OF THE PROJECT OWNER/MANAGEMENT ASSOCIATION...
MOWING FREQUENCIES: MOWING FREQUENCIES WILL DEPEND ON FIELD CONDITIONS...
MOWING SHOULD BE DONE THREE (3) TIMES DURING THE ESTABLISHMENT PERIOD:

Table with 4 columns: ACTIVITY, TIMING, SUGGESTED MOWING HEIGHTS, REASON. Rows include FIRST MOWING, SECOND MOWING, and THIRD MOWING.

MOWING TIMES ARE APPROXIMATE: ACTUAL MOWING TIMES SHOULD BE BASED ON THE GROWTH OF NATURAL GRASSES AND UNDESIRABLE WEEDS.

AFTER THE DESIRED VEGETATION HAS BECOME ESTABLISHED THE FIRST AND SECOND MOWINGS (MAY, AUGUST) MAY NOT BE NECESSARY...
BURNING (IF APPROPRIATE FOR SITE): PRIOR TO BURNING, CONTACT WITH THE LOCAL MUNICIPALITY / FIRE DEPARTMENT IS REQUIRED...

IF ALLOWED BY LOCAL CODE AND ORDINANCES, ONLY BURN WHEN THE DEAD VEGETATION MATTER CAN SUSTAIN FIRE...
L300



POTHS GENERAL DEVELOPMENT
76TH AND RAWSON
FRANKLIN, WI 53132
LANDSCAPE SPECIFICATIONS

PRELIMINARY
NOT FOR
CONSTRUCTION

Table with 2 columns: FIELD NO., VALUE. Rows include SCALE, PROJECT NO., DESIGN DATE, PLOT DATE, DRAWN BY, CHECKED BY, APPROVED BY, SHEET NO.

L300



ALLEE OF UPRIGHT TREES



ORNAMENTAL GRASS MASS PLANTINGS



MULTIPLE TONES OF PURPLE AND SILVER



TEXTURAL PLANTINGS



MIXTURE OF PERENNIALS AND ORNAMENTAL GRASSES - SITE MONUMENT SIGN AREAS



GROUNDCOVER WITH TREE ALLEE

LANDSCAPE DESIGN INTENT

LAND BY LABEL - POTHS GENERAL



TEXTURAL PLANTINGS



AMPHITHEATER LANDSCAPE BACKDROP



ORNAMENTAL GRASS MASS PLANTINGS

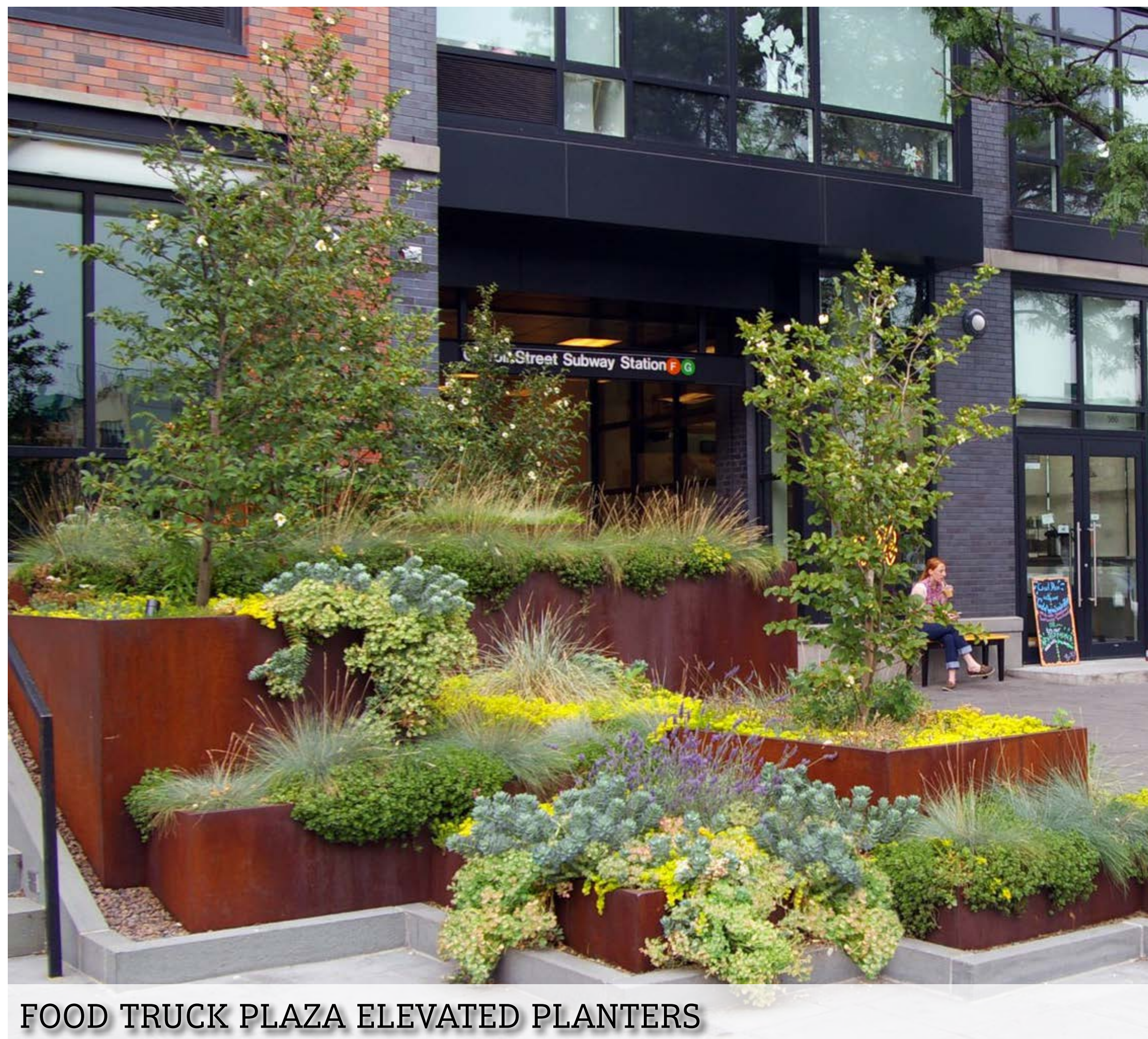

FOOD TRUCK PLAZA ELEVATED PLANTERS



FOOD TRUCK PLAZA TREE PLANTINGS



OUTDOOR AMPHITHEATER OPPORTUNITIES

LANDSCAPE DESIGN INTENT

LAND BY LABEL - POTHS GENERAL